

# Port Hedland Boulevard

Wilson Street, Port Hedland, Western Australia

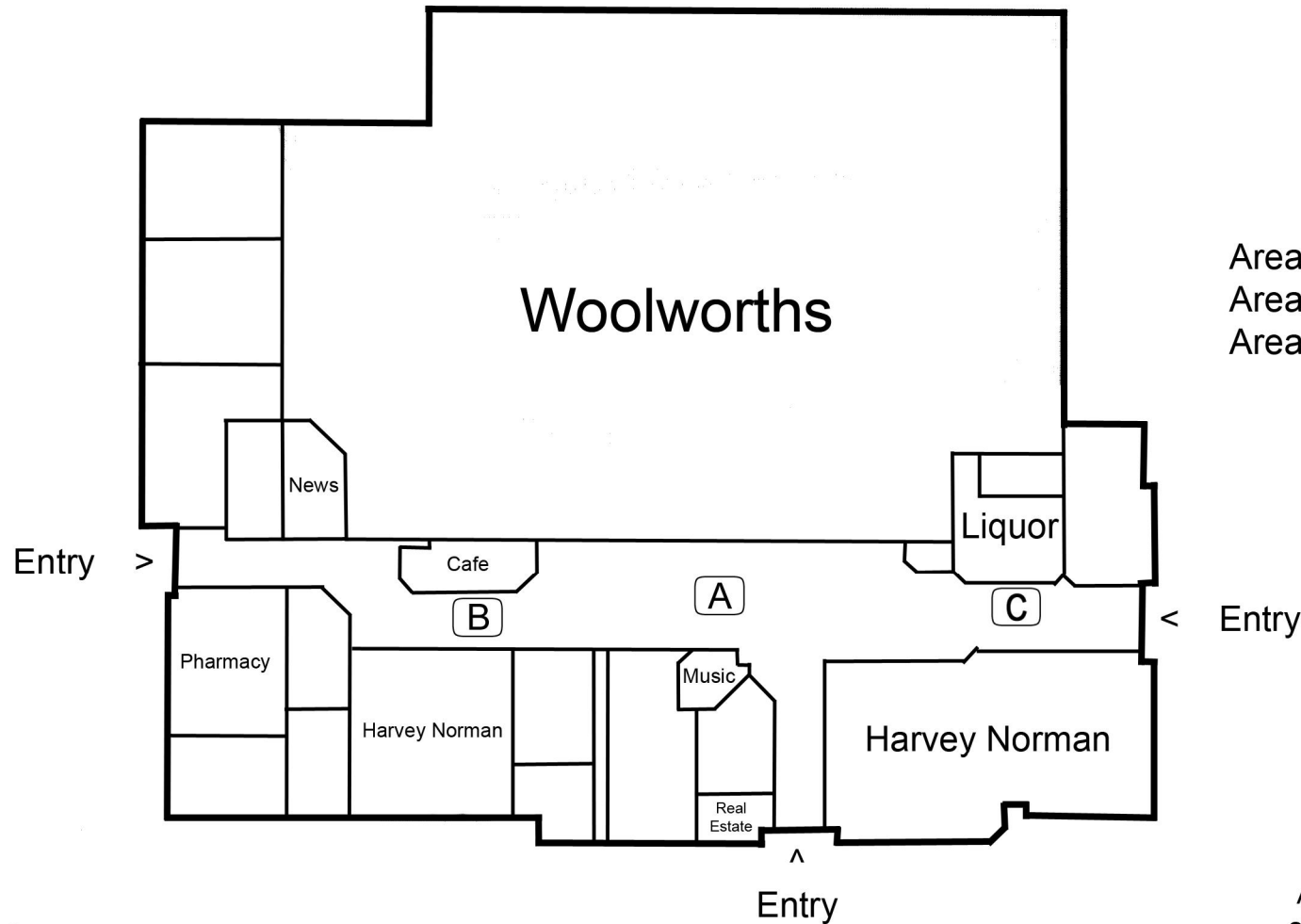

Area A	3.0m x 3.0m	\$715.00
Area B	3.6m x 2.0m	\$715.00
Area C	3.0m x 2.0m	\$715.00

All prices include GST, and are subject to change without notice

Areas shown are for location identification only and are not to scale  
Plan updated 24/02/2015

